



星野上
Starwild Glamping

Starwild Polaris

Embrace Nature's' Embrace

Parameters	Configuration	Weight
Overall Dimension(m)/ Area(m ²)	3.5*4.2*2.8m / 14.7m ²	180kg
Interior Dimension(m)/ Area(m ²)	3.3*4.0*2.65m / 13.2m ²	
Volume	1.35m ³	
Wooden Carton Dimension	Standard carton: 480*50*60cm Window frame carton: 180*150*12cm	



Outer Tent Parameters

750g PVC Blackout Fabric
Waterproof Pressure (420000 mm)
UV Protection: UPF 50+
Flame Retardant: B2
Tear Resistance: Warp 2558N / Weft 2024N
Mildew Resistant、 Self-Cleaning

Inner Tent Parameters

430g TC Cotton
Waterproof Pressure (500 mm)
UV Protection: UPF 40+
Tear Resistance: Warp 1665N / Weft 1021N
Mosquito-Resistant/ Breathable

Frame Parameters

Main Tube: Φ60mm Galvanized Steel Pipe, 2.0mm Thickness
Connection Tube: Φ70mm Galvanized Steel Pipe, 4.0mm Thickness
TIG Welding (Tungsten Inert Gas Welding)
Outdoor-Specific Baking Paint Finish (Resistant To Sunlight And Rain)



(3D Render-Exploded View
-Standard)

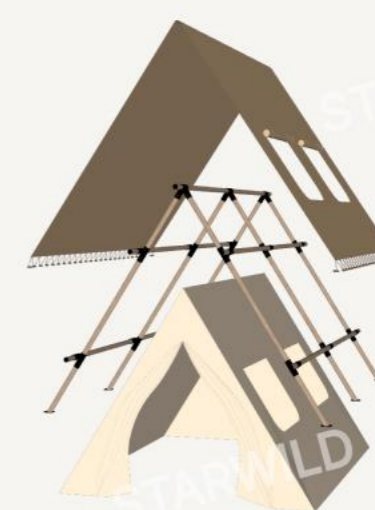

(3D Render-Exploded View
-Mini)



(3D Render-Assembly View
-Standard)



(3D Render-Assembly View
-Mini)

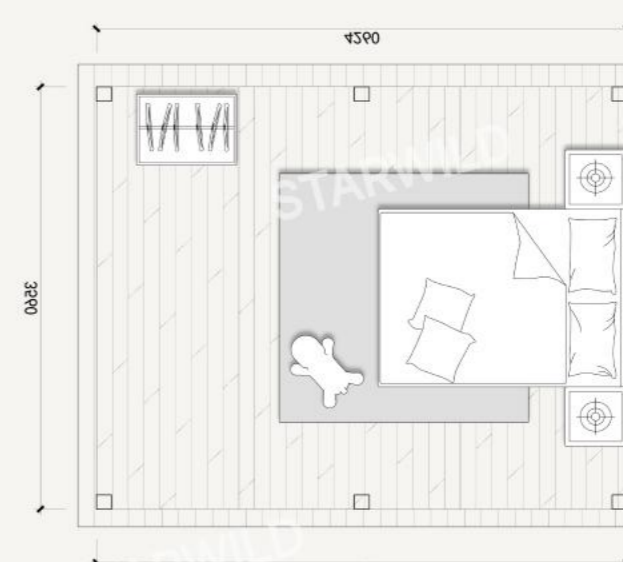

(Floor Plan)

INTERIOR SPACE DIAGRAM

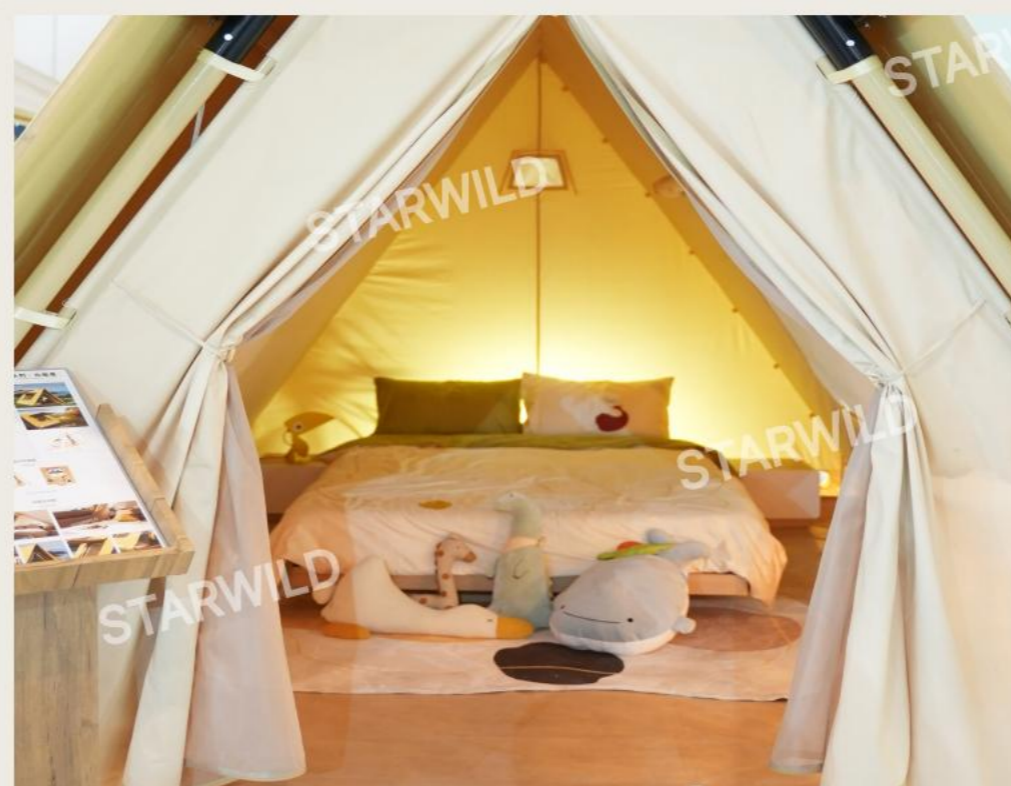

OPTIONAL ACCESSORIES



Decking System



Door/Window System



Hydraulic Rod Windows



Connection Tube

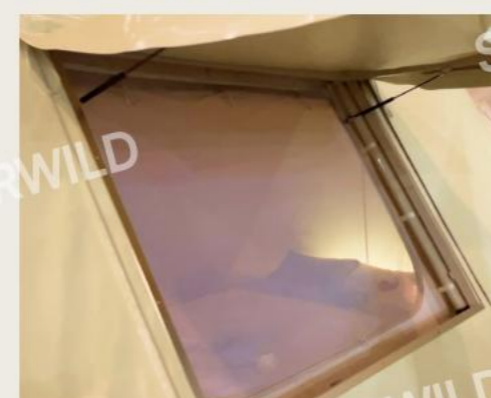

Mosquito Netting



Corner Ground Fixing



Interior System



Insulation System